

01

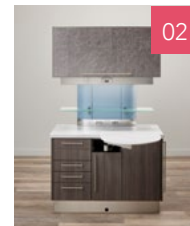

02

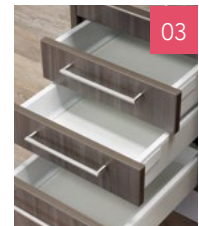

03

Midmark Artizan Expressions cabinetry offers rich and timeless elements from traditional to modern styles for a distinctive expression that is all your own. Let us help you create a warm and inviting space built to withstand the rigors of the dental environment

## DESIGN FLEXIBILITY

The Artizan Expressions cabinetry collection can be customized to meet your visual preferences as well as your ergonomic workflow, infection control, technology integration and unique storage requirements.

Want to see more color options? Use our dental design tool to help find your individual style and visualize what your operatory and sterilization space will look like.

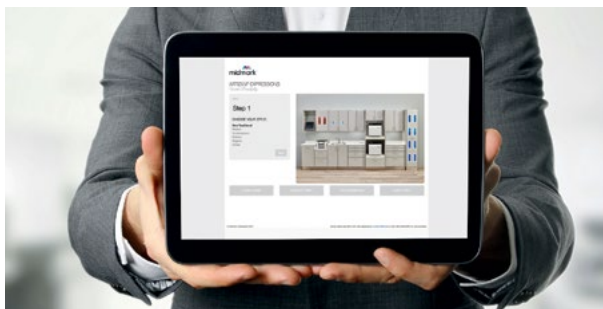

**DENTAL  
DESIGN TOOL**  
[apps.midmark.com/  
dental-design-tool](https://apps.midmark.com/dental-design-tool)

### 01 Distinctive Design

Artizan Expressions breaks the stereotype of clinical-looking dental cabinetry. Features like the treatment station's sleek slim profile midsection and the central station's stylish vanity front and Ultraleather® accents complete a picture of refinement in any dental office.

### 02 Expressive Style

Choose from a wide variety of plush accent upholstery, artful resin panels, woodgrain and solid cabinet panels, and durable countertop selections to create a style all your own.

### 03 Attention to Detail

We use only quality components and materials on every cabinet we build. This collection delivers quality construction with seamless, stainless steel bases, soft-close doors and drawers, 3/4" panel construction and brushed nickel handles.

# ARTIZAN® EXPRESSIONS

## TECHNICAL SPECIFICATIONS



**Base:** Seamless 16-gauge 304 stainless steel with Camar® leg cups and adjustable leveling feet

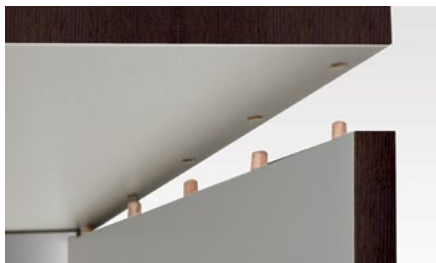

**Structure:** ¾" THK 42-46# medium density particle board core with thermally fused melamine coating (white); glued wood dowel frameless construction

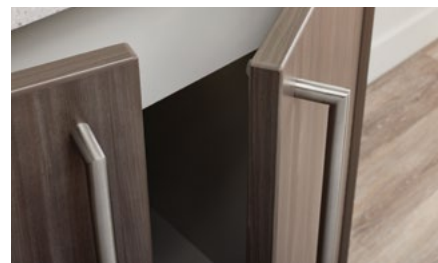

**Door and Drawer Fronts:** ¾" THK 42-46# medium-density particle board core with thermally fused melamine coating (standard color offering) with 3-mm PVC edgebanding



**Drawer Systems:** Soft-close, full extension Blum® TANDEMBOX® intivo® drawers (Silk White); full extension steel ball bearing slides, 100 lb capacity; 5/8" THK 42-46# medium-density particle board core with thermally fused melamine coating (white) bottom and back

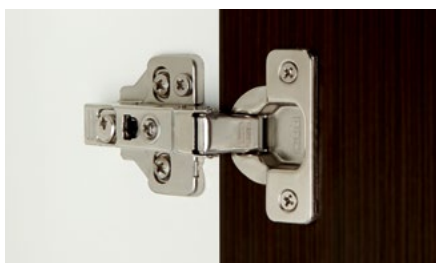

**Hinges:** Soft-close, concealed European style 110° opening angle, inset, half and full overlay options

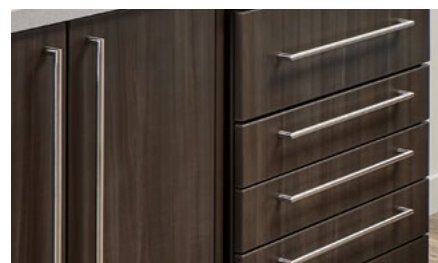

**Pulls:** Steel, brushed/satin nickel finish



**Resin Panels:** 1/8" THK Lumicor® Lumiform™ (PETG) ecoshield and Lumishield EX™ (PC) resin with a satin finish



**Upholstered Panels:** Ultrafabrics® Ultraleather upholstery material

Camar is a registered trademark owned by Camar S.p.A.  
Ultraleather and Ultrafabrics are registered trademarks owned by Ultrafabrics, LLC.  
Lumicor, Lumiform and Lumishield EX are trademarks owned by Lumicor, Inc.  
Blum, TANDEMBOX and intivo are registered trademarks owned by Julius Blum GmbH.

© 2024 Midmark Corporation, Versailles, Ohio USA. All rights reserved.  
007-10069-00 Rev D1 (7/24)